



MM Systems Corporation

50 MM Way, Pendergrass, GA 30567 • 800.241.3460 • 706.824.7500 • [www.mmsystemscorp.com](http://www.mmsystemscorp.com)

# **EXPANSION JOINT SYSTEMS**

**FOR**

# **AIRPORTS AND RELATED FACILITIES**

**A PARTIAL LIST OF PROJECTS**

**PROVIDED BY**

**MM SYSTEMS CORPORATION**



**C. Michael Schuerman**  
*Executive Vice President*

Dear Valued Client:

Enclosed please find a copy of our Airport Portfolio . . . . dozens of successful projects furnished by MM Systems over our five decades of experience.

Founded in 1960, MM Systems Corporation offers thermal, seismic, fire-rated and waterproof movement joint systems that meet the rigorous demands of airport terminals, parking structures and ancillary buildings. Our total engineered solutions approach provides integrated system design, consultation and installation support to architects, engineers and contractors.

We at MM Systems have been enhancing and adding to our portfolio of expansion joint products for airports. The portfolio includes newly engineered designs, enhanced versions of widely accepted, field proven products and new technology designed to provide performance and durability for the lifetime of the facility.

Also, we have been working with our Certified Contractor Network focusing on the “built-in” quality assurance features of each of the systems. MM Systems can provide your design team with a list of Certified Contractors capable of insuring a quality and timely installation.

We look forward to supporting your design team as we strive to be recognized as the “Can Do” company when it comes to expansion joints and our other product lines that include trench grates, access covers, column covers, and custom architectural metalworking – all helping change the look, style and longevity of your structure.

Sincerely,

MM Systems Corporation

C. Michael Schuerman  
Executive Vice President



# INDEX

Bradley International Airport  
Burlington International Airport  
BWI Airport  
Denver International Airport  
Dulles International Airport  
Hobby Airport  
George Bush Intercontinental Airport  
Hartsfield Jackson International Airport  
JFK International Airport  
Logan International Airport  
McCarran International Airport  
Mexico City International Airport  
Miami International Airport  
Montgomery Regional Airport  
Minneapolis-St. Paul International Airport  
National Airport  
Newark International Airport  
O'Hare International Airport  
Omaha Airport  
Orlando International Airport  
Palm Beach International Airport  
Pensacola Regional Airport  
Philadelphia International Airport  
Portland International Airport  
Quebec City International Airport  
Raleigh-Durham International Airport  
Richmond International Airport  
Salt Lake City International Airport  
San Antonio International Airport  
San Jose International Airport  
SeaTac International Airport  
SFO International Airport  
T.F. Green State Airport  
Tampa International Airport  
Toledo Express Airport  
Toronto International Airport  
Wilmington International Airport



# Bradley International Airport

# Project Profile

MM Systems Corp. • 50 MM Way, Pendergrass, GA 30567 • 800.241.3460 • 706.824.7500 • www.mmssystemscorp.com

**Project:**  
Bradley International Airport  
Windsor Locks, Connecticut

**Owner:**  
Connecticut Dept. of Transportation

## Bradley International Airport



### Expansion Joint Systems

#### Silicone Impregnated Foam

- ± 50% seismic movement capability with near zero tensile stress at bond line.
- Conforms to irregular openings virtually eliminating the risk of costly water damage.
- Binary silicone seal and impregnated foam nearly eliminates possibility of punctures.
- Permanently elastic and will expand and accommodate the required joint movement.
- Watertight, dust-proof, airtight, soundproof seal resilient and flexible to -39°F.
- Provides interior vapor, dust, acoustical, air and sound-dampening control.

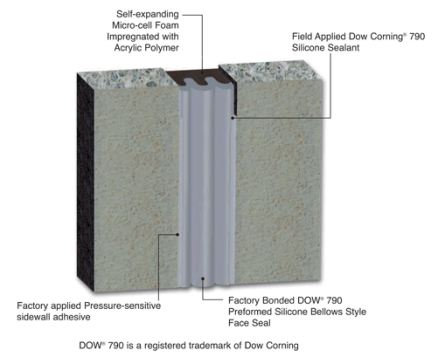

### Flushline Systems

- Flush Elastoprene® gasket minimizes sightline.
- Gaskets available in 8 coordinating designer colors.
- Matching sightlines for floors & walls available.
- Wide range of frame styles accommodates various conditions.
- Single and dual seal designs provide necessary movement ranges.

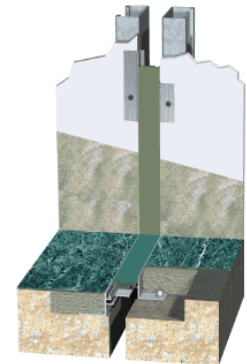

### Vertical Sealing System

- No visible aluminum or hardware.
- Engineered for multi-directional seismic movement.
- Visual seals are available in standard and custom colors.
- Resistant to UV, ozone, acid rain, most chemicals and extreme temperatures.
- Splices can be heat welded or bonded with specialty adhesive.
- Continuous lengths in most applications.

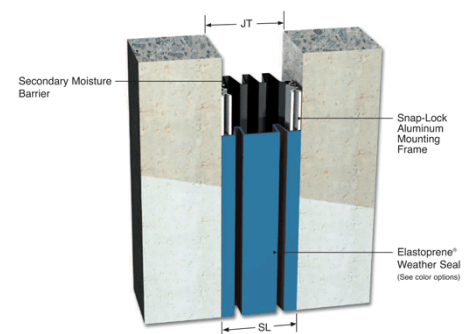



# Burlington International Airport

# Project Profile

MM Systems Corp. • 50 MM Way, Pendergrass, GA 30567 • 800.241.3460 • 706.824.7500 • www.mmsystemscorp.com

**Project:**  
Burlington International Airport  
South Burlington, Vermont

**Owner:**  
City of Burlington

## Burlington International Airport



## Expansion Joint Systems

### Flushline Systems

- Flush Elastoprene® gasket minimizes sightline.
- Gaskets available in 8 coordinating designer colors.
- Matching sightlines for floors & walls available.
- Wide range of frame styles accommodates various conditions.
- Single and dual seal designs provide necessary movement ranges.

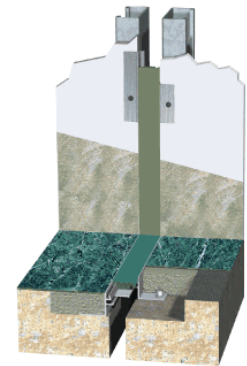

### Vertical Sealing System

- No visible aluminum or hardware.
- Engineered for multi-directional seismic movement.
- Visual seals are available in standard and custom colors.
- Resistant to UV, ozone, acid rain, most chemicals and extreme temperatures.
- Splices can be heat welded or bonded with specialty adhesive. Continuous lengths in most applications.

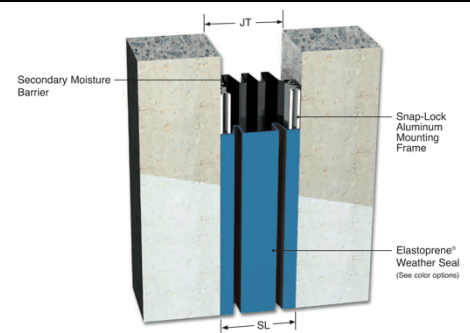

### Pyro-Flex Fire Barrier

- ASTM Test Standards E-119, E1399 and E-1966.
- Additional Standards: UL 263, UL 2079, UBC 43-1, UBC 7-1, ANSI A2.1 and NFPA 251.
- Available in 2, 3 and 4 hour ratings and cycle tested for class I, II and III movement including lateral shear.
- Listed with UL, Omega Point Laboratories, Intertek, California State Fire Marshall and ICBO Evaluation Services.

### Pyro-Flex / Blockout Floor Series

High performance continuous floor fire barrier system that maintains a seal to prevent smoke and fire spread when used with any floor expansion joint system.

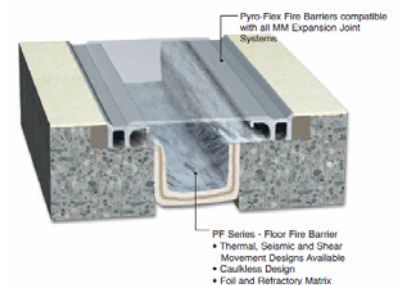



# Baltimore/Washington International Thurgood Marshall Airport

## Project:

Baltimore Washington International  
Thurgood Marshall Airport  
Parking Garage  
Washington DC

## Owner:

Maryland Aviation Administration

## BWI Airport



## Expansion Joint Systems

### Rubber Safety Cover System

- For covering expansion joints openings with recessed joint systems or fillers.
- Ideal for high traffic pedestrian areas.
- Safety Cover with rubber impact/nosing pads that flex independently.
- Rated for low speed vehicular traffic.
- Heavy-duty convex shaped aluminum cover with raised slip-resistant pattern.
- Provides smooth transition between uneven surfaces.
- Convex aluminum cover accommodates greater vertical offsets.
- Complies with ADA guidelines.

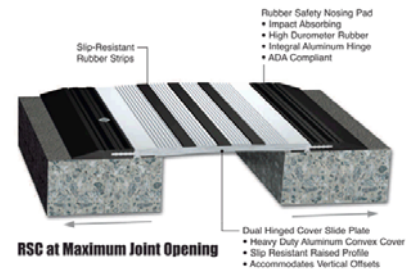

### Metal Wall and Ceiling Systems

- Available in aluminum (standard), brass or stainless laminate covers.
- Standard clear anodized, optional bronze anodized or available Kynar® 500/Hylar® 5000 finishes in 72 standard and custom colors.
- Isolation seal protects finishes during movement.
- Frame design accommodates wall and ceiling applications.

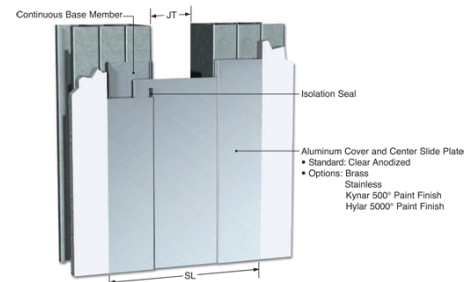

### Pyro-Flex Fire Barrier

- ASTM Test Standards E-119, E1399 and E-1966.
- Additional Standards: UL 263, UL 2079, UBC 43-1, UBC 7-1, ANSI A2.1 and NFPA 251.
- Available in 2, 3 and 4 hour ratings and cycle tested for class I, II and III movement including lateral shear.
- Listed with UL, Omega Point Laboratories, Intertek, California State Fire Marshall and ICBO Evaluation Services.

### Pyro-Flex / Blockout Floor Series

High performance continuous floor fire barrier system that maintains a seal to prevent smoke and fire spread when used with any floor expansion joint system.

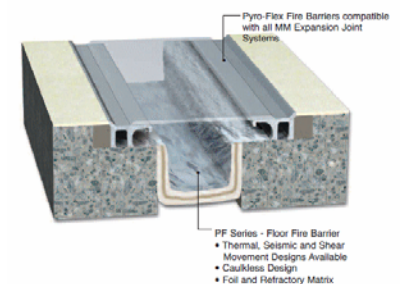



# Denver International Airport

# Project Profile

MM Systems Corp. • 50 MM Way, Pendergrass, GA 30567 • 800.241.3460 • 706.824.7500 • www.mmsystemscorp.com

## Project:

Denver International Airport  
Parking Garage  
Denver, Colorado

## Owner:

City and County of Denver  
Department of Aviation

## Denver Airport



## Expansion Joint Systems

### ElastoLok Membrane System

- slip resistant surface for severe applications and extreme weather conditions.
- Metal reinforced rubber panels lock down continuous wing of Elastoprene® membrane seal.
- Specialty bedding compound insures a watertight seal to the concrete deck.
- Ultimate durability for loading docks, ramps, bridges, fork trucks, snow plows and buses.
- Seal profiles are ADA compliant and can be heat welded or adhesive bonded.
- Available with five-year warranty through Certified Contractor Network.

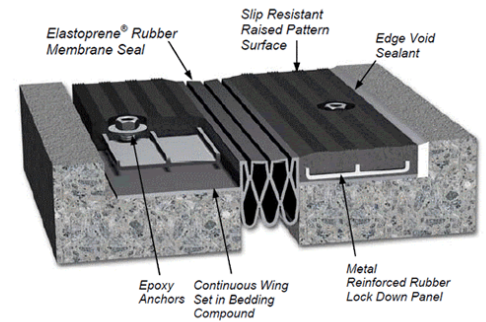

### Silicone Impregnated Foam System

- ± 50% seismic movement capability with near zero tensile stress at bond line.
- Conforms to irregular openings virtually eliminating the risk of costly water damage.
- Binary silicone seal and impregnated foam nearly eliminates possibility of punctures.
- Permanently elastic and will expand and accommodate the required joint movement.
- Watertight, dust-proof, airtight, soundproof seal resilient and flexible to -39°F.
- Provides interior vapor, dust, acoustical, air and sound-dampening control.

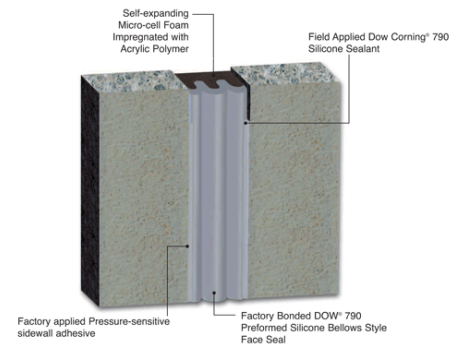

DOW® 790 is a registered trademark of Dow Corning



# Washington Dulles International Airport

# Project Profile

MM Systems Corp. • 50 MM Way, Pendergrass, GA 30567 • 800.241.3460 • 706.824.7500 • www.mmssystemscorp.com

**Project:**  
Washington Dulles International Airport  
Dulles, Virginia

**Owner:**  
Metropolitan Washington  
Airports Authority

Dulles Airport



## Expansion Joint Systems

### Classic Cover Systems

- Durable architectural aluminum frames and covers.
- Exposed or recessed receiver cover styles.
- Optional recessed frames accept a variety of floor finishes: carpet, tile, etc.

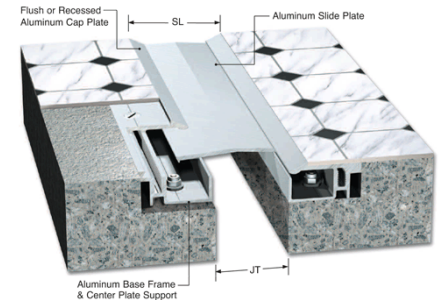

### Metal Wall and Ceiling Systems

- Available in aluminum (standard), brass or stainless laminate covers.
- Standard clear anodized, optional bronze anodized or available Kynar® 500/Hylar® 5000 finishes in 72 standard and custom colors.
- Isolation seal protects finishes during movement.
- Frame design accommodates wall and ceiling applications.

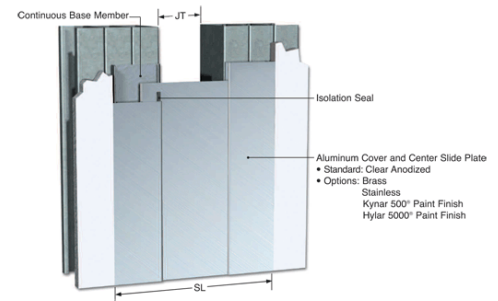

### Flushline Systems

- Flush Elastoprene® gasket minimizes sightline.
- Gaskets available in 8 coordinating designer colors.
- Matching sightlines for floors & walls available.
- Wide range of frame styles accommodates various conditions.
- Single and dual seal designs provide necessary movement ranges.

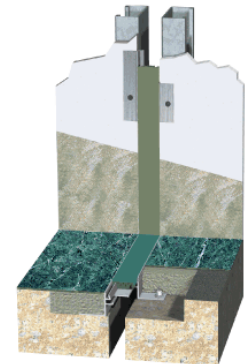



# William P. Hobby Airport

**Project:**  
William P. Hobby Airport  
Houston, Texas

**Owner:**  
City of Houston

## Hobby Airport



### Expansion Joint Systems

#### Heavy Duty Floor Cover Systems

- Rugged, extra heavy-duty designs are engineered for heavy loads.
- Surface mount and block-out installation styles.
- Thermal and seismic movement range designs.
- Shallow bevel, minimal bump designs accommodate wheel traffic.

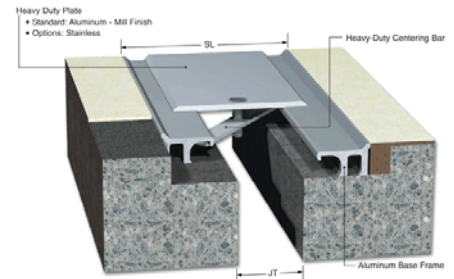

#### Flexible Wall and Ceiling Systems

- Seals available in coordinating decorator colors.
- Multiple styles accommodate various conditions.
- Replaceable Elastoprene® seals for maintenance or décor changes.
- Mud-in frame (model VSW) for gypsum walls reduces exposed surface sightline.

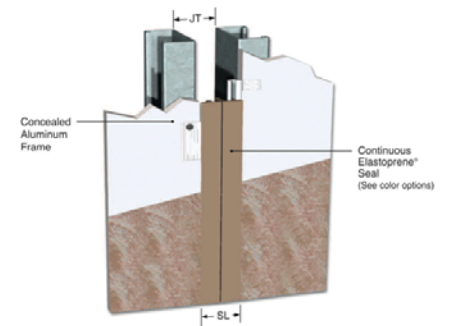

#### Rubber Safety Cover System

- For covering expansion joints openings with recessed joint systems or fillers.
- Ideal for high traffic pedestrian areas.
- Safety Cover with rubber impact/nosing pads that flex independently.
- Rated for low speed vehicular traffic.
- Heavy-duty convex shaped aluminum cover with raised slip-resistant pattern.
- Provides smooth transition between uneven surfaces.
- Convex aluminum cover accommodates greater vertical offsets.
- Complies with ADA guidelines.





# George Bush Intercontinental Airport

# Project Profile

MM Systems Corp. • 50 MM Way, Pendergrass, GA 30567 • 800.241.3460 • 706.824.7500 • www.mmssystemscorp.com

**Project:**  
George Bush Intercontinental Airport  
Terminal C  
Houston, Texas

**Owner:**  
Houston Airport Systems

## IAH Airport



## Expansion Joint Systems LokCrete Membrane System

- High performance monolithic waterproof expansion joint sealing system.
- Capable of thermal, seismic, vertical and lateral shear movement.
- Membrane seal with perforated wings bonded to deck with impact absorbing elastomeric concrete.
- LokCrete® is a hard, elastic, abrasion resistant embed material that flexes with deck loads.
- No primers required - bonds directly to concrete, aluminum and steel.
- ADA compliant low profile seal design accommodates post tension cables and conduit.
- Resistant to UV, ozone, acid rain, most chemicals and extreme temperatures.
- Available with five-year warranty through Certified Contractor Network.

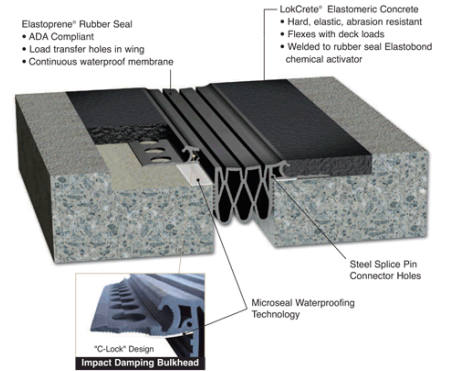

## Elastoprene Compression Seal System

- No mechanical anchors or metal components.
- Splices can be heat welded or bonded with specialty adhesive.
- Seal profiles are ADA compliant and provide a smooth transition for pedestrian traffic areas.
- Model ECS is available in continuous lengths for horizontal applications.
- High abrasion and ultraviolet resistance.
- Cost effective and easy to install.

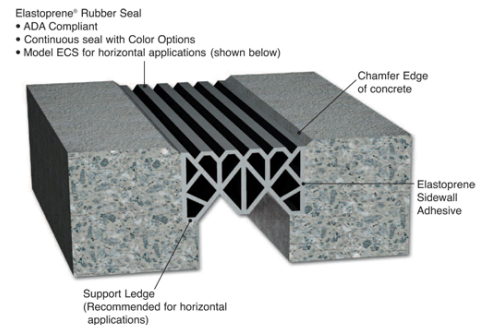

## Vertical Sealing System

- No visible aluminum or hardware.
- Engineered for multi-directional seismic movement.
- Visual seals are available in standard and custom colors.
- Resistant to UV, ozone, acid rain, most chemicals and extreme temperatures.
- Splices can be heat welded or bonded with specialty adhesive. Continuous lengths in most applications.

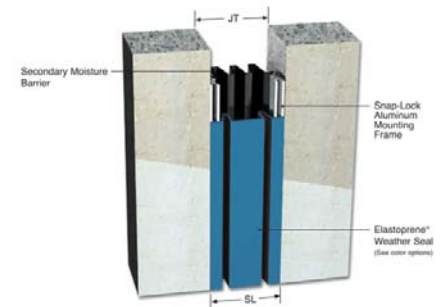



# Hartsfield Jackson Atlanta International Airport

# Project Profile

MM Systems Corp. • 50 MM Way, Pendergrass, GA 30567 • 800.241.3460 • 706.824.7500 • www.mmssystemscorp.com

## Hartsfield Jackson Airport



**Project:**  
Hartsfield Jackson Atlanta International Airport  
Atlanta, Georgia

**Owner:**  
City of Atlanta

## Expansion Joint Systems

### Split Slab Dual Self-Healing Seismic System

- Custom created for Hartsfield Jackson Airport
- Two systems combined - SHD System (Self-healing Dual Seal System) combined with SSM System (Split Slab Membrane System)
- Leg height adjusts to accommodate pavers, split-slabs and other topping surfaces.
- Watertight self-expanding acrylic impregnated foam conforms to irregular openings virtually eliminating the risk of costly water damage.
- Monolithic seal with dual impregnation process provides integral "self" healing and sealing capability.
- Seismic Rotation Dowel facilitates zero tensile stress at epoxy bond lines and provides multi-directional seismic movement capability.

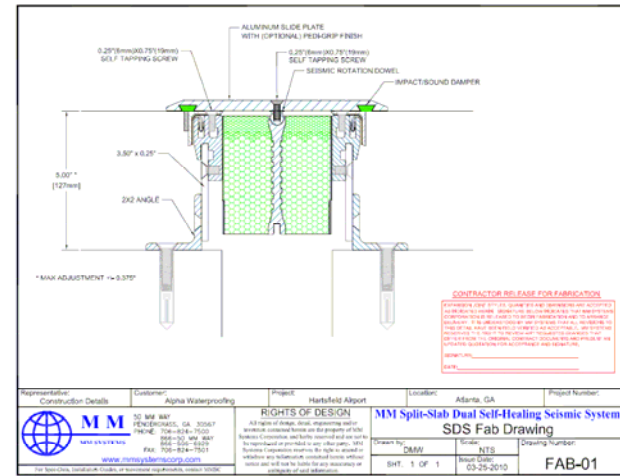

### Pyro-Flex Fire Barrier

- ASTM Test Standards E-119, E1399 and E-1966.
- Additional Standards: UL 263, UL 2079, UBC 43-1, UBC 7-1, ANSI A2.1 and NFPA 251.
- Available in 2, 3 and 4 hour ratings and cycle tested for class I, II and III movement including lateral shear.
- Listed with UL, Omega Point Laboratories, Intertek, California State Fire Marshall and ICBO Evaluation Services.

### Pyro-Flex / Blockout Floor Series

High performance continuous floor fire barrier system that maintains a seal to prevent smoke and fire spread when used with any floor expansion joint system.

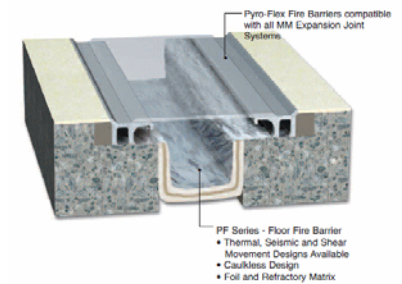



# John F. Kennedy International Airport

# Project Profile

MM Systems Corp. • 50 MM Way, Pendergrass, GA 30567 • 800.241.3460 • 706.824.7500 • www.mmsystemscorp.com

## Project:

John F. Kennedy International Airport  
American Airlines Terminal  
Queens, New York

## Owner:

City of New York

JFK Airport



## Expansion Joint Systems

### Vertical Sealing System

- No visible aluminum or hardware.
- Engineered for multi-directional seismic movement.
- Visual seals are available in standard and custom colors.
- Resistant to UV, ozone, acid rain, most chemicals and extreme temperatures.
- Splices can be heat welded or bonded with specialty adhesive. Continuous lengths in most applications.

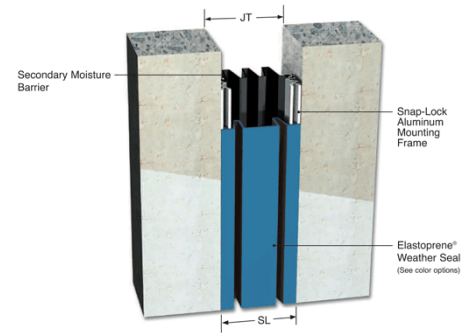



# General Edward Lawrence Logan International Airport

**Project:**  
Logan International Airport  
Boston, Massachusetts

**Owner:**  
Massachusetts Port Authority

Logan Airport



## Expansion Joint Systems

### Flushline Systems

- Flush Elastoprene® gasket minimizes sightline.
- Gaskets available in 8 coordinating designer colors.
- Matching sightlines for floors & walls available.
- Wide range of frame styles accommodates various conditions.
- Single and dual seal designs provide necessary movement ranges.

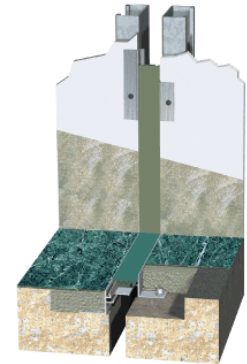

### Surface Mount Metal Cover Systems

- No block-out design reduces installation costs.
- Simple, durable designs accommodate a variety of floor finishes.
- Cost-effective solution for simple spans.
- No block-outs or recess required in concrete decks or gym floors.
- Thermal and seismic movement range designs.

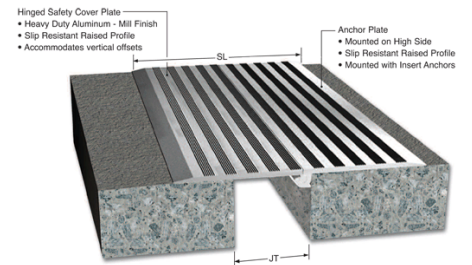

### Seismic Floor Cover Systems

- Centering bar cover system accommodates full seismic movement range.
- Wide range of size/style combinations accommodates various conditions.
- Recess or surface bearing cover styles.
- Available in aluminum (standard), brass and stainless steel covers.

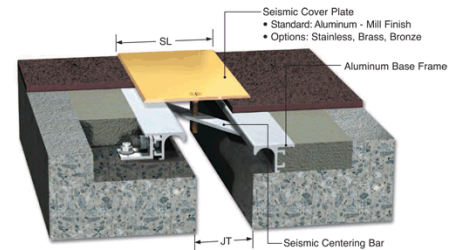



# McCarran International Airport

**Project:**  
McCarran Airport  
Parking Garage  
Las Vegas, Nevada

**Owner:**  
Clark County

## McCarran Airport



## Expansion Joint Systems

### Seismic Slide Plate System

- Load rated heavy-duty metal slide plate with impact and sound dampener.
- Interlocking frame design insures proper alignment.
- Slide plate available in stainless steel and aluminum.
- For wide joints with multi-directional seismic movement.
- Seismic centering device with dynamic load impact dampener.
- Recessed extension plates allow smooth slab-to-slab transition.

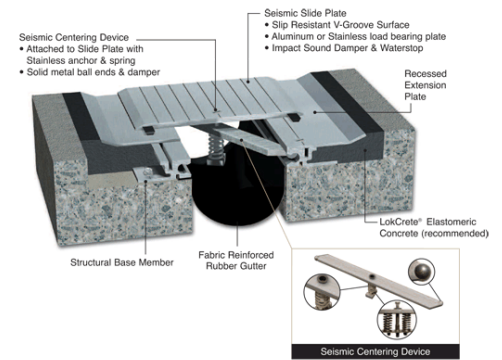

### ElastoLok Membrane System

- slip resistant surface for severe applications and extreme weather conditions.
- Metal reinforced rubber panels lock down continuous wing of Elastoprene® membrane seal.
- Specialty bedding compound insures a watertight seal to the concrete deck.
- Ultimate durability for loading docks, ramps, bridges, fork trucks, snow plows and buses.
- Seal profiles are ADA compliant and can be heat welded or adhesive bonded.
- Available with five-year warranty through Certified Contractor Network.

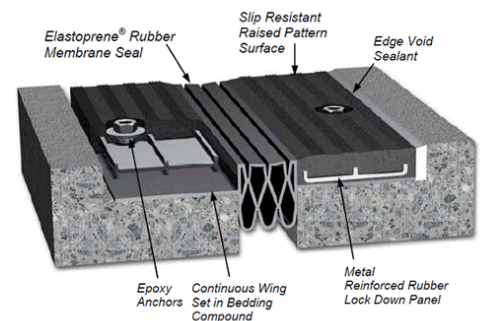

### Hinged Safety Cover System

- Load rated heavy-duty aluminum slide plate with impact and sound dampener.
- Hinge design accommodates vertical offsets in concrete decks.
- Integral fabric reinforced rubber waterproofing gutter.
- Available with optional LokCrete® Bedding Compound.
- ADA compliant design with slip resistant raised pattern surface.

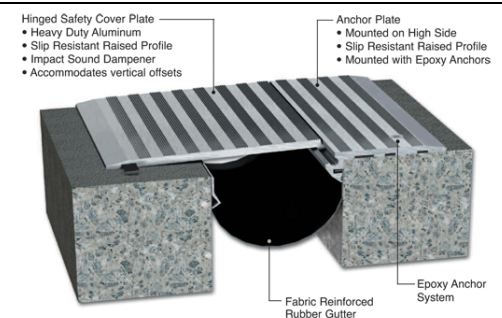



# Mexico City International Airport

# Project Profile

MM Systems Corp. • 50 MM Way, Pendergrass, GA 30567 • 800.241.3460 • 706.824.7500 • www.mmsystemscorp.com

**Project:**  
Mexico City International Airport  
Mexico City, Mexico

**Owner:**  
Grupo Aeroportuario de la Ciudad de México

Mexico City Airport



---

## Expansion Joint Systems

### Classic Cover Systems

- Durable architectural aluminum frames and covers.
- Exposed or recessed receiver cover styles.
- Optional recessed frames accept a variety of floor finishes: carpet, tile, etc.

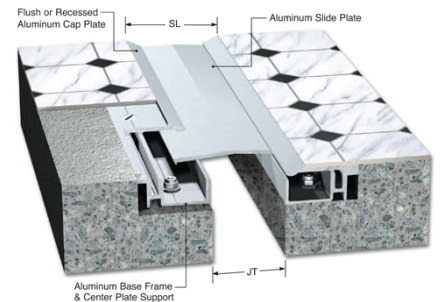



# Miami International Airport

**Project:**  
Miami International Airport  
Miami, Florida

**Owner:**  
Miami-Dade County

## Miami Airport



## Expansion Joint Systems

### Rubber Safety Cover System

- For covering expansion joints openings with recessed joint systems or fillers.
- Ideal for high traffic pedestrian areas.
- Safety Cover with rubber impact/nosing pads that flex independently.
- Rated for low speed vehicular traffic.
- Heavy-duty convex shaped aluminum cover with raised slip-resistant pattern.
- Provides smooth transition between uneven surfaces.
- Convex aluminum cover accommodates greater vertical offsets.
- Complies with ADA guidelines.



### Metal Roof and Wall Joint Systems

- Aluminum systems feature seismic centering bars.
- Aluminum covers may be engineered to resist snow and wind loads.
- Standard mill finish, optional clear and bronze anodized or available Kynar® 500/Hylar® 5000 finishes in 72 standard and custom colors.

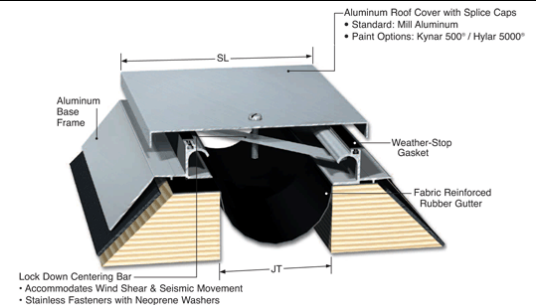

### Pyro-Flex Fire Barrier

- ASTM Test Standards E-119, E1399 and E-1966.
- Additional Standards: UL 263, UL 2079, UBC 43-1, UBC 7-1, ANSI A2.1 and NFPA 251.
- Available in 2, 3 and 4 hour ratings and cycle tested for class I, II and III movement including lateral shear.
- Listed with UL, Omega Point Laboratories, Intertek, California State Fire Marshall and ICBO Evaluation Services.

### Pyro-Flex / Blockout Floor Series

High performance continuous floor fire barrier system that maintains a seal to prevent smoke and fire spread when used with any floor expansion joint system.

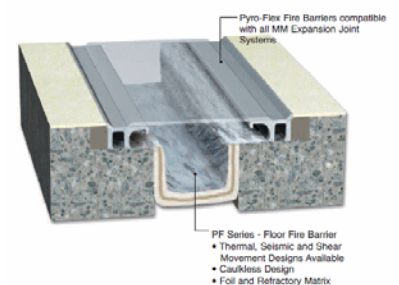



## Montgomery Regional Airport

**Project:**  
Montgomery Regional Airport  
Montgomery, Alabama

**Owner:**  
Montgomery Airport Authority

### Montgomery Airport



### Expansion Joint Systems

#### Vertical Sealing System

- No visible aluminum or hardware.
- Engineered for multi-directional seismic movement.
- Visual seals are available in standard and custom colors.
- Resistant to UV, ozone, acid rain, most chemicals and extreme temperatures.
- Splices can be heat welded or bonded with specialty adhesive. Continuous lengths in most applications.

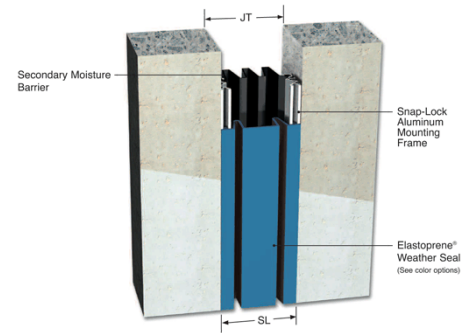

#### Pyro-Flex Fire Barrier

- ASTM Test Standards E-119, E1399 and E-1966.
- Additional Standards: UL 263, UL 2079, UBC 43-1, UBC 7-1, ANSI A2.1 and NFPA 251.
- Available in 2, 3 and 4 hour ratings and cycle tested for class I, II and III movement including lateral shear.
- Listed with UL, Omega Point Laboratories, Intertek, California State Fire Marshall and ICBO Evaluation Services.

#### Pyro-Flex / Blockout Floor Series

High performance continuous floor fire barrier system that maintains a seal to prevent smoke and fire spread when used with any floor expansion joint system.

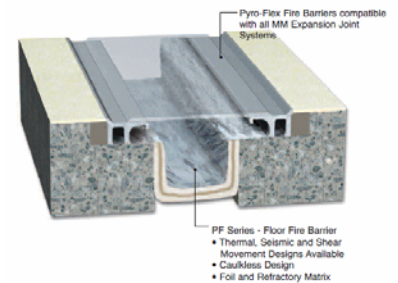



# Minneapolis-St. Paul International Airport

**Project:**  
Minneapolis-St. Paul International Airport  
Minneapolis, Minnesota

**Owner:**  
MAC

## MSP Airport



## Expansion Joint Systems

### Metal Wall and Ceiling Systems

- Available in aluminum (standard), brass or stainless laminate covers.
- Standard clear anodized, optional bronze anodized or available Kynar® 500/Hylar® 5000 finishes in 72 standard and custom colors.
- Isolation seal protects finishes during movement.
- Frame design accommodates wall and ceiling applications.

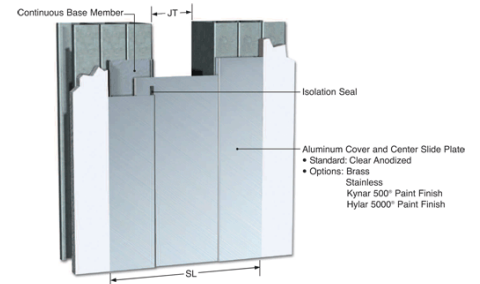

### Classic Cover Systems

- Durable architectural aluminum frames and covers.
- Exposed or recessed receiver cover styles.
- Optional recessed frames accept a variety of floor finishes: carpet, tile, etc.

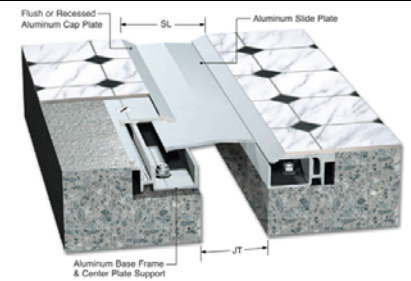

## Pyro-Flex / Blockout Floor Series

High performance continuous floor fire barrier system that maintains a seal to prevent smoke and fire spread when used with any floor expansion joint system.

### Pyro-Flex Fire Barrier

- ASTM Test Standards E-119, E1399 and E-1966.
- Additional Standards: UL 263, UL 2079, UBC 43-1, UBC 7-1, ANSI A2.1 and NFPA 251.
- Available in 2, 3 and 4 hour ratings and cycle tested for class I, II and III movement including lateral shear.
- Listed with UL, Omega Point Laboratories, Intertek, California State Fire Marshall and ICBO Evaluation Services.

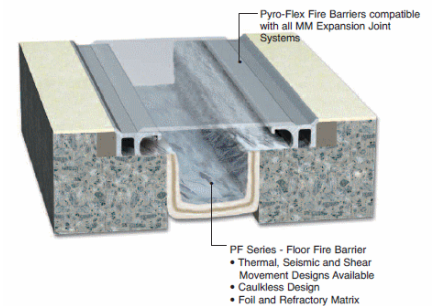



# Ronald Reagan National Washington Airport

# Project Profile

MM Systems Corp. • 50 MM Way, Pendergrass, GA 30567 • 800.241.3460 • 706.824.7500 • www.mmsystemscorp.com

**Project:**  
Ronald Reagan National Washington Airport  
Washington D.C.

**Owner:**  
Metropolitan Washington Airports Authority

## National Airport



## Expansion Joint Systems

### Epoxy Bonded Sealing System

- No blockouts required - waterproof sealing system becomes integral with concrete deck.
- Tenacious thixotropic epoxy anchoring system bonds seal to concrete, aluminum and steel.
- ADA compliant seal profile provides pedestrian friendly walking surface.
- Engineered to withstand heavy traffic loads, UV, ozone, acid rain, most chemicals and extreme temperatures.
- Capable of thermal, seismic, vertical and lateral shear movement.
- Accommodates complex miters and changes in direction.
- Available with 5-year warranty through Certified Contractor Network.

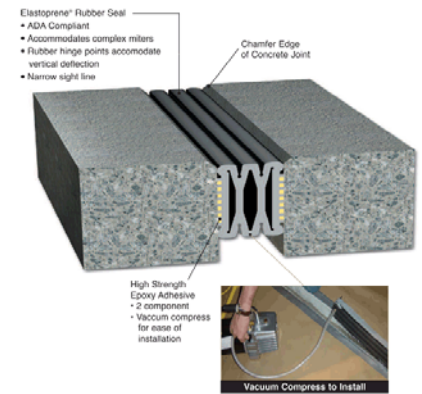

### Heavy Duty Floor Cover Systems

- Rugged, extra heavy-duty designs are engineered for heavy loads.
- Surface mount and block-out installation styles.
- Thermal and seismic movement range designs.
- Shallow bevel, minimal bump designs accommodate wheel traffic.

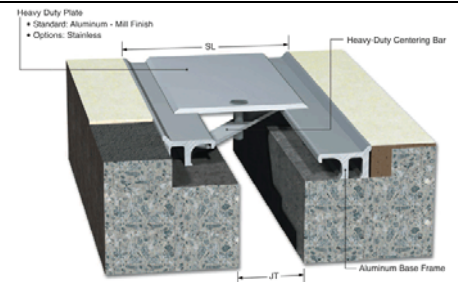

### Metal Wall and Ceiling Systems

- Available in aluminum (standard), brass or stainless laminate covers.
- Standard clear anodized, optional bronze anodized or available Kynar® 500/Hylar® 5000 finishes in 72 standard and custom colors.
- Isolation seal protects finishes during movement.
- Frame design accommodates wall and ceiling applications.

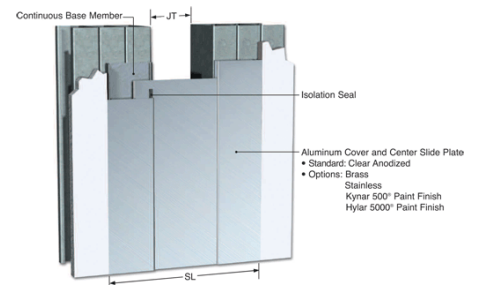



# Newark Liberty International Airport

# Project Profile

MM Systems Corp. • 50 MM Way, Pendergrass, GA 30567 • 800.241.3460 • 706.824.7500 • www.mmsystems.com

**Project:**  
Newark Liberty International Airport  
Newark, New Jersey

**Owner:**  
City of Newark

## Newark Airport



## Expansion Joint Systems

### Epoxy Bonded Sealing System

- No blockouts required - waterproof sealing system becomes integral with concrete deck.
- Tenacious thixotropic epoxy anchoring system bonds seal to concrete, aluminum and steel.
- ADA compliant seal profile provides pedestrian friendly walking surface.
- Engineered to withstand heavy traffic loads, UV, ozone, acid rain, most chemicals and extreme temperatures.
- Capable of thermal, seismic, vertical and lateral shear movement.
- Accommodates complex miters and changes in direction.
- Available with 5-year warranty through Certified Contractor Network.

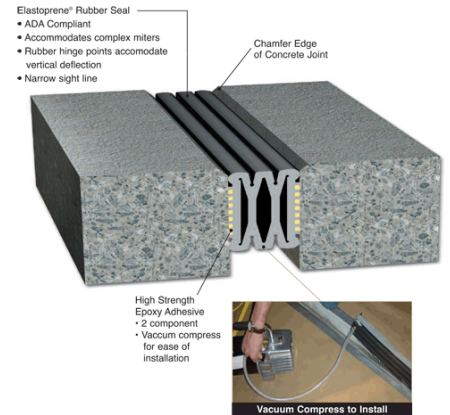

### Metal Wall and Ceiling Systems

- Available in aluminum (standard), brass or stainless laminate covers.
- Standard clear anodized, optional bronze anodized or available Kynar® 500/Hylar® 5000 finishes in 72 standard and custom colors.
- Isolation seal protects finishes during movement.
- Frame design accommodates wall and ceiling applications.

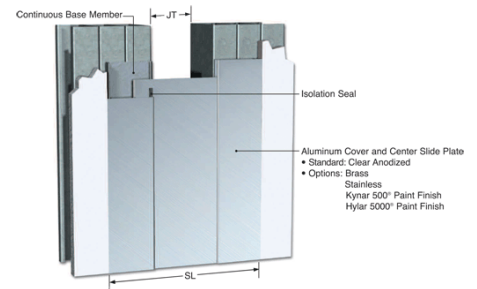

### Pyro-Flex Fire Barrier

- ASTM Test Standards E-119, E1399 and E-1966.
- Additional Standards: UL 263, UL 2079, UBC 43-1, UBC 7-1, ANSI A2.1 and NFPA 251.
- Available in 2, 3 and 4 hour ratings and cycle tested for class I, II and III movement including lateral shear.
- Listed with UL, Omega Point Laboratories, Intertek, California State Fire Marshall and ICBO Evaluation Services.

### Pyro-Flex / Blockout Floor Series

High performance continuous floor fire barrier system that maintains a seal to prevent smoke and fire spread when used with any floor expansion joint system.

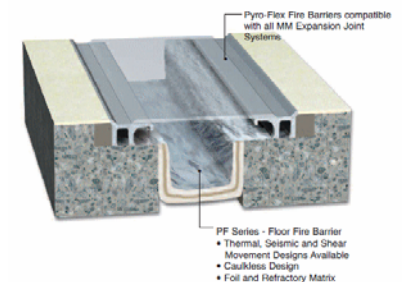



# O'Hare International Airport

**Project:**  
O'Hare International Airport Elevated  
Parking Structure Expansion Joint  
Replacement  
Chicago, Illinois

**Owner:**  
City of Chicago

O'Hare Airport



## Expansion Joint Systems

### Armored Strip Bolt-In Membrane System

- High performance monolithic waterproof expansion joint sealing system.
- Armored Stainless Steel retaining angle protects continuous Elastoprene seal.
- Heavy Duty frame with punched holes bonded to deck with impact absorbing elastomeric concrete.
- LokCrete® is a hard, elastic, abrasion resistant embed material that flexes with deck loads.
- Capable of thermal, seismic, vertical and lateral shear movement.
- ADA compliant seal design provides pedestrian friendly walking surface.
- Resistant to UV, ozone, acid rain, most chemicals and extreme temperatures.
- A warranty may be available through Certified Contractor Network.

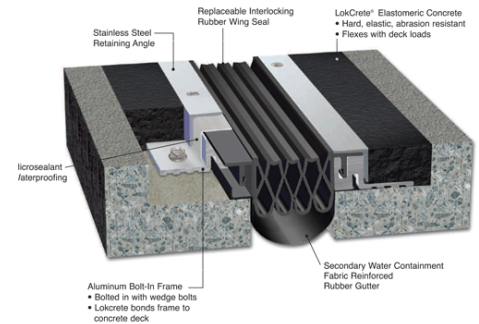

### Expanding Impregnated Seismic Foam System

- ± 50% movement capability.
- Vehicular/Traffic Grade Silicone Surface Seal.
- Conforms to irregular openings reducing the risk of costly water damage.
- System generates constant outward pressure providing a permanent weather-tight seal.
- Epoxy bonded acrylic impregnated foam block provides additional point load support.
- Permanently elastic and will expand and accommodate the concrete structures movement under extreme weather conditions.
- Resistant to UV, ozone, acid rain, wind driven rain and extreme temperatures.
- Easy to install, no fasteners or anchors.
- Will not bleed like asphalt or bitumen based impregnated products.
- Resilient and flexible to -39°F.
- Provides interior vapor, dust, acoustical, air and sound-damping control.
- Fire Barriers - MM expansion joint systems are available with appropriate fire ratings.

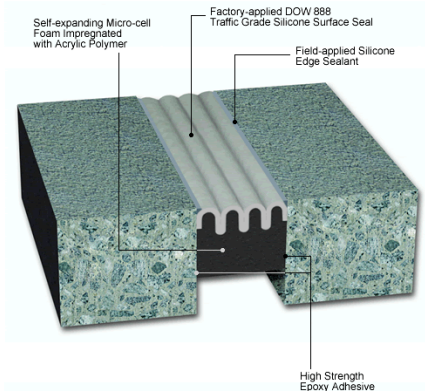



# Omaha Airport

**Project:**  
Omaha Airport  
Parking Garage  
Omaha, Nebraska

**Owner:**  
Keith Edquist

## Omaha Airport



## Expansion Joint Systems

### LokCrete Membrane System

- High performance monolithic waterproof expansion joint sealing system.
- Capable of thermal, seismic, vertical and lateral shear movement.
- Membrane seal with perforated wings bonded to deck with impact absorbing elastomeric concrete.
- LokCrete® is a hard, elastic, abrasion resistant embed material that flexes with deck loads.
- No primers required - bonds directly to concrete, aluminum and steel.
- ADA compliant low profile seal design accommodates post tension cables and conduit.
- Resistant to UV, ozone, acid rain, most chemicals and extreme temperatures.
- Available with five-year warranty through Certified Contractor Network.

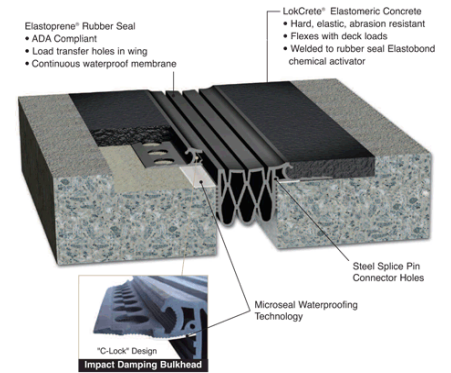

### ElastoLok Membrane System

- slip resistant surface for severe applications and extreme weather conditions.
- Metal reinforced rubber panels lock down continuous wing of Elastoprene® membrane seal.
- Specialty bedding compound insures a watertight seal to the concrete deck.
- Ultimate durability for loading docks, ramps, bridges, fork trucks, snow plows and buses.
- Seal profiles are ADA compliant and can be heat welded or adhesive bonded.
- Available with five-year warranty through Certified Contractor Network.

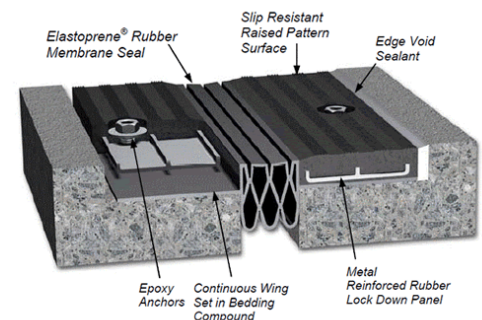

# Orlando International Airport

## Orlando Airport



**Project:**  
Orlando International Airport  
Orlando, Florida

**Owner:**  
Greater Orlando Aviation Authority

## Expansion Joint Systems

### Flexible Wall and Ceiling Systems

- Seals available in coordinating decorator colors.
- Multiple styles accommodate various conditions.
- Replaceable Elastoprene® seals for maintenance or décor changes.
- Mud-in frame (model VSW) for gypsum walls reduces exposed surface sightline.

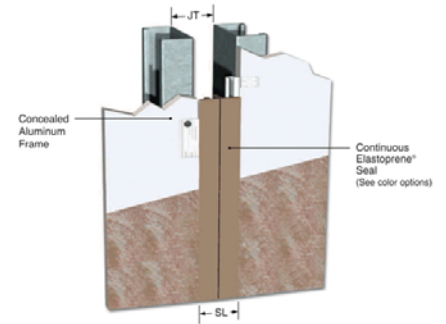

### Metal Wall and Ceiling Systems

- Available in aluminum (standard), brass or stainless laminate covers.
- Standard clear anodized, optional bronze anodized or available Kynar® 500/Hylar® 5000 finishes in 72 standard and custom colors.
- Isolation seal protects finishes during movement.
- Frame design accommodates wall and ceiling applications.

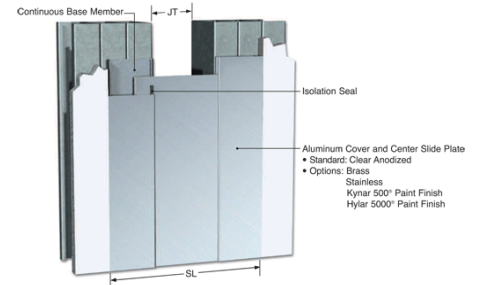



# Palm Beach International Airport

# Project Profile

MM Systems Corp. • 50 MM Way, Pendergrass, GA 30567 • 800.241.3460 • 706.824.7500 • www.mmsystems.com

**Project:**  
Palm Beach International Airport  
West Palm Beach, Florida

**Owner:**  
Palm Beach County  
Department of Airports

Palm Beach Airport



## Expansion Joint Systems

### Flushline Systems

- Flush Elastoprene® gasket minimizes sightline.
- Gaskets available in 8 coordinating designer colors.
- Matching sightlines for floors & walls available.
- Wide range of frame styles accommodates various conditions.
- Single and dual seal designs provide necessary movement ranges.

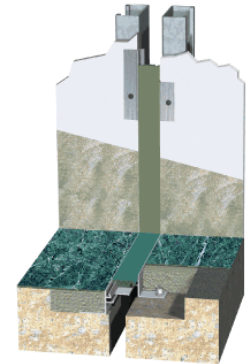

### Flexible Wall and Ceiling Systems

- Seals available in coordinating decorator colors.
- Multiple styles accommodate various conditions.
- Replaceable Elastoprene® seals for maintenance or décor changes.
- Mud-in frame (model VSW) for gypsum walls reduces exposed surface sightline.

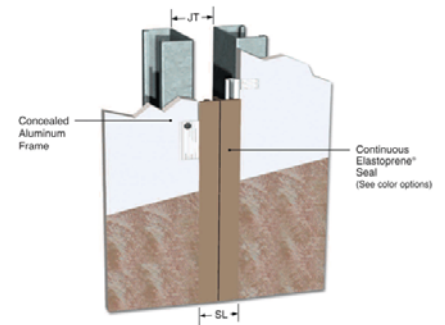

### Pyro-Flex Fire Barrier

- ASTM Test Standards E-119, E1399 and E-1966.
- Additional Standards: UL 263, UL 2079, UBC 43-1, UBC 7-1, ANSI A2.1 and NFPA 251.
- Available in 2, 3 and 4 hour ratings and cycle tested for class I, II and III movement including lateral shear.
- Listed with UL, Omega Point Laboratories, Intertek, California State Fire Marshall and ICBO Evaluation Services.

### Pyro-Flex / Blockout Floor Series

High performance continuous floor fire barrier system that maintains a seal to prevent smoke and fire spread when used with any floor expansion joint system.

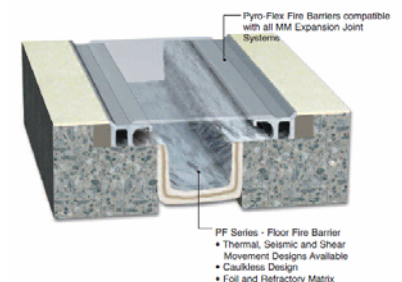

- Thermal, Seismic and Shear Movement Designs Available
- Crackless Design
- Foli and Retractory Matrix



# Pensacola Gulf Coast Regional Airport

# Project Profile

MM Systems Corp. • 50 MM Way, Pendergrass, GA 30567 • 800.241.3460 • 706.824.7500 • www.mmsystemscorp.com

**Project:**  
Pensacola Gulf Coast Regional Airport  
Pensacola, Florida

**Owner:**  
City of Pensacola

## Pensacola Airport



## Expansion Joint Systems

### Classic Cover Systems

- Durable architectural aluminum frames and covers.
- Exposed or recessed receiver cover styles.
- Optional recessed frames accept a variety of floor finishes: carpet, tile, etc.

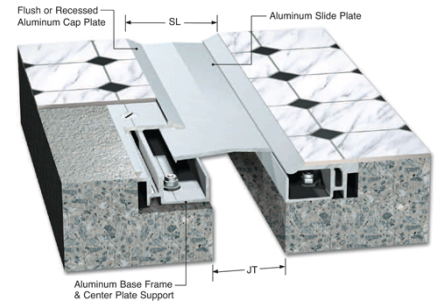

### Flexible Wall and Ceiling Systems

- Seals available in coordinating decorator colors.
- Multiple styles accommodate various conditions.
- Replaceable Elastoprene® seals for maintenance or décor changes.
- Mud-in frame (model VSW) for gypsum walls reduces exposed surface sightline.

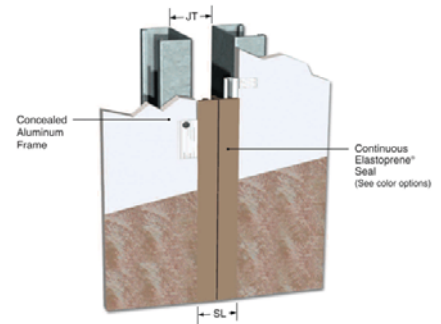



# Philadelphia International Airport

# Project Profile

MM Systems Corp. • 50 MM Way, Pendergrass, GA 30567 • 800.241.3460 • 706.824.7500 • www.mmsystemscorp.com

## Project:

Philadelphia International Airport  
Philadelphia, Pennsylvania

## Owner:

City of Philadelphia

## Philadelphia Airport



## Expansion Joint Systems

### Metal Wall and Ceiling Systems

- Available in aluminum (standard), brass or stainless laminate covers.
- Standard clear anodized, optional bronze anodized or available Kynar® 500/Hylar® 5000 finishes in 72 standard and custom colors.
- Isolation seal protects finishes during movement.
- Frame design accommodates wall and ceiling applications.

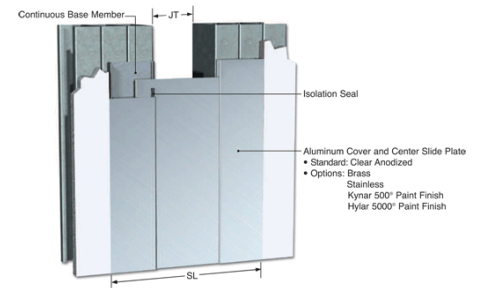

### Flexible Wall and Ceiling Systems

- Seals available in coordinating decorator colors.
- Multiple styles accommodate various conditions.
- Replaceable Elastoprene® seals for maintenance or décor changes.
- Mud-in frame (model VSW) for gypsum walls reduces exposed surface sightline.

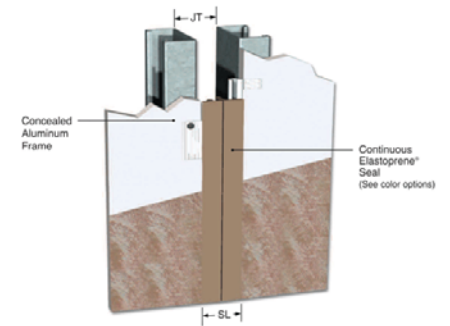

### Metal Roof and Wall Joint Systems

- Aluminum systems feature seismic centering bars.
- Aluminum covers may be engineered to resist snow and wind loads.
- Standard mill finish, optional clear and bronze anodized or available Kynar® 500/Hylar® 5000 finishes in 72 standard and custom colors.

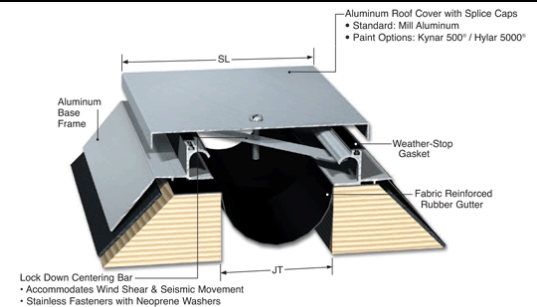



## Portland International Airport

**Project:**  
Portland International Airport  
Portland, Oregon

**Owner:**  
Port of Portland

Portland Airport



---

### Expansion Joint Systems

#### Flushline Systems

- Flush Elastoprene® gasket minimizes sightline.
- Gaskets available in 8 coordinating designer colors.
- Matching sightlines for floors & walls available.
- Wide range of frame styles accommodates various conditions.
- Single and dual seal designs provide necessary movement ranges.

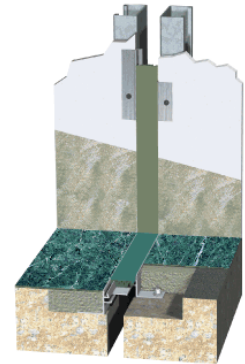



# Quebec City Jean Lesage International Airport

**Project:**  
Quebec City Jean Lesage International Airport  
Quebec City, Quebec, Canada

**Owner:**  
Transport Canada

## Quebec City Airport



## Expansion Joint Systems

### No Bump Floor Cover Systems

- Flush, no-bump designs ideal for bump sensitive applications.
- Variable recesses accommodate a variety of floor finishes: carpet, tile, terrazzo, stone pavers, etc.
- Thermal and seismic movement range designs. No Bump Systems remain flush only during thermal movement cycles (generally in interior, climate controlled environments). During seismic or other extreme movements, No Bump Systems will not remain flush to adjacent floor surfaces.
- Available in aluminum (standard), brass and stainless steel covers.

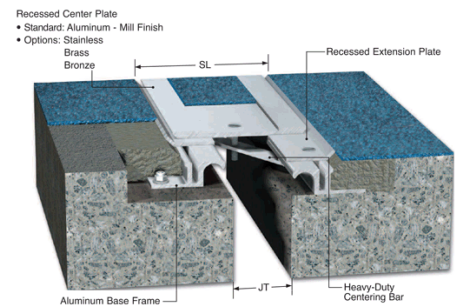



# Raleigh-Durham International Airport

# Project Profile

MM Systems Corp. • 50 MM Way, Pendergrass, GA 30567 • 800.241.3460 • 706.824.7500 • www.mmssystemscorp.com

**Project:**  
Raleigh-Durham International Airport  
Morrisville, North Carolina

**Owner:**  
Raleigh-Durham Airport Authority

Raleigh-Durham Airport



## Expansion Joint Systems

### Flexible Wall and Ceiling Systems

- Seals available in coordinating decorator colors.
- Multiple styles accommodate various conditions.
- Replaceable Elastoprene® seals for maintenance or décor changes.
- Mud-in frame (model VSW) for gypsum walls reduces exposed surface sightline.

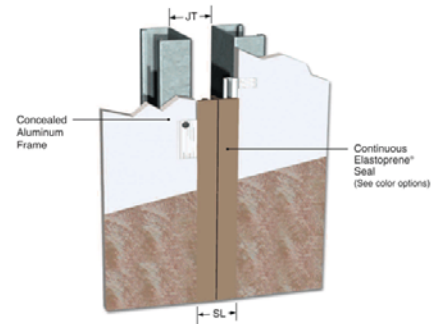

### Flushline Systems

- Flush Elastoprene® gasket minimizes sightline.
- Gaskets available in 8 coordinating designer colors.
- Matching sightlines for floors & walls available.
- Wide range of frame styles accommodates various conditions.
- Single and dual seal designs provide necessary movement ranges.

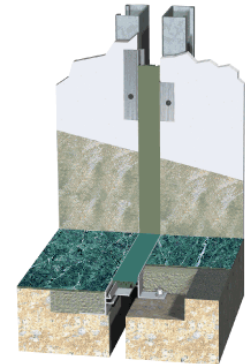

### Pyro-Flex Fire Barrier

- ASTM Test Standards E-119, E1399 and E-1966.
- Additional Standards: UL 263, UL 2079, UBC 43-1, UBC 7-1, ANSI A2.1 and NFPA 251.
- Available in 2, 3 and 4 hour ratings and cycle tested for class I, II and III movement including lateral shear.
- Listed with UL, Omega Point Laboratories, Intertek, California State Fire Marshall and ICBO Evaluation Services.

### Pyro-Flex / Blockout Floor Series

High performance continuous floor fire barrier system that maintains a seal to prevent smoke and fire spread when used with any floor expansion joint system.

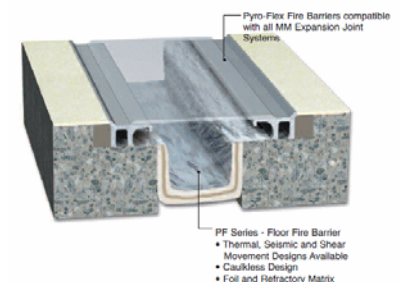



# Richmond International Airport

**Project:**  
Richmond International Airport  
Sandston, Virginia

**Owner:**  
Capitol Region Airport Commission

Richmond Airport



## Expansion Joint Systems

### Metal Wall and Ceiling Systems

- Available in aluminum (standard), brass or stainless laminate covers.
- Standard clear anodized, optional bronze anodized or available Kynar® 500/Hylar® 5000 finishes in 72 standard and custom colors.
- Isolation seal protects finishes during movement.
- Frame design accommodates wall and ceiling applications.

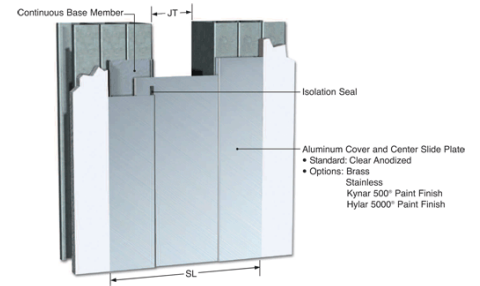

### Vertical Sealing System

- No visible aluminum or hardware.
- Engineered for multi-directional seismic movement.
- Visual seals are available in standard and custom colors.
- Resistant to UV, ozone, acid rain, most chemicals and extreme temperatures.
- Splices can be heat welded or bonded with specialty adhesive. Continuous lengths in most applications.

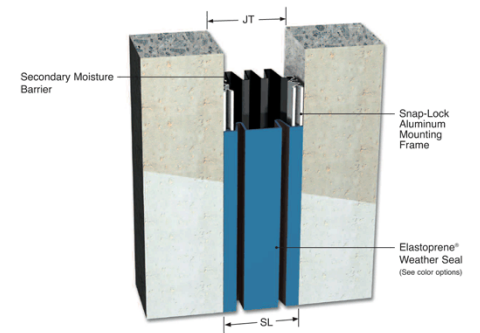

### Flushline Systems

- Flush Elastoprene® gasket minimizes sightline.
- Gaskets available in 8 coordinating designer colors.
- Matching sightlines for floors & walls available.
- Wide range of frame styles accommodates various conditions.
- Single and dual seal designs provide necessary movement ranges.

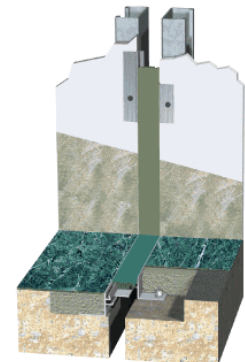



# Salt Lake City International Airport

## Salt Lake City Airport



**Project:**  
Salt Lake City International Airport  
Salt Lake City, Utah

**Owner:**  
Salt Lake City

## Expansion Joint Systems

### LokCrete Membrane System

- High performance monolithic waterproof expansion joint sealing system.
- Capable of thermal, seismic, vertical and lateral shear movement.
- Membrane seal with perforated wings bonded to deck with impact absorbing elastomeric concrete.
- LokCrete® is a hard, elastic, abrasion resistant embed material that flexes with deck loads.
- No primers required - bonds directly to concrete, aluminum and steel.
- ADA compliant low profile seal design accommodates post tension cables and conduit.
- Resistant to UV, ozone, acid rain, most chemicals and extreme temperatures.
- Available with five-year warranty through Certified Contractor Network.

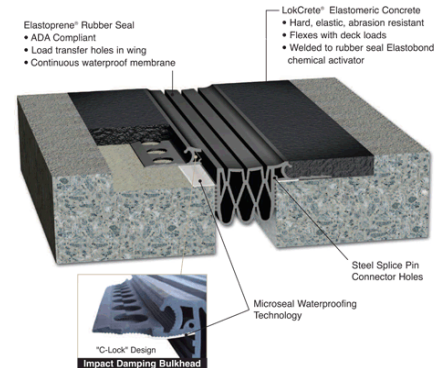

### Metal Roof and Wall Joint Systems

- Aluminum systems feature seismic centering bars.
- Aluminum covers may be engineered to resist snow and wind loads.
- Standard mill finish, optional clear and bronze anodized or available Kynar® 500/Hylar® 5000 finishes in 72 standard and custom colors.

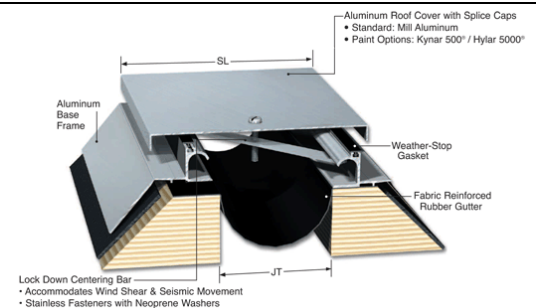



# San Antonio International Airport

# Project Profile

MM Systems Corp. • 50 MM Way, Pendergrass, GA 30567 • 800.241.3460 • 706.824.7500 • www.mmssystemscorp.com

**Project:**  
San Antonio International Airport  
San Antonio, Texas

**Operator:**  
City of San Antonio Aviation Department

## San Antonio Airport



## Expansion Joint Systems

### Epoxy Bonded Sealing System

- No blockouts required - waterproof sealing system becomes integral with concrete deck.
- Tenacious thixotropic epoxy anchoring system bonds seal to concrete, aluminum and steel.
- ADA compliant seal profile provides pedestrian friendly walking surface.
- Engineered to withstand heavy traffic loads, UV, ozone, acid rain, most chemicals and extreme temperatures.
- Capable of thermal, seismic, vertical and lateral shear movement.
- Accommodates complex miters and changes in direction.
- Available with 5-year warranty through Certified Contractor Network.

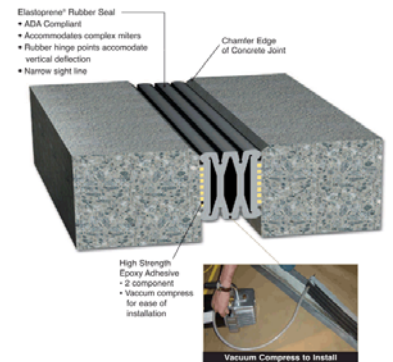

### Flushline Systems

- Flush Elastoprene® gasket minimizes sightline.
- Gaskets available in 8 coordinating designer colors.
- Matching sightlines for floors & walls available.
- Wide range of frame styles accommodates various conditions.
- Single and dual seal designs provide necessary movement ranges.

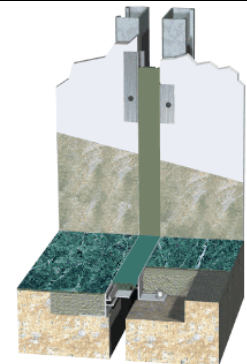

### Flexible Wall and Ceiling Systems

- Seals available in coordinating decorator colors.
- Multiple styles accommodate various conditions.
- Replaceable Elastoprene® seals for maintenance or décor changes.
- Mud-in frame (model VSW) for gypsum walls reduces exposed surface sightline.

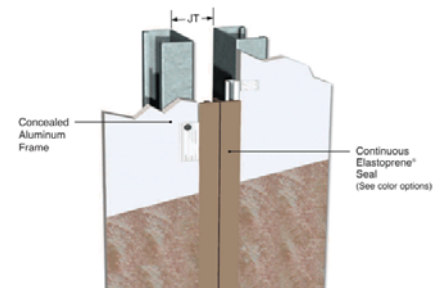



# Norman Y. Mineta San Jose International Airport

# Project Profile

MM Systems Corp. • 50 MM Way, Pendergrass, GA 30567 • 800.241.3460 • 706.824.7500 • www.mmsystemscorp.com

**Project:**  
Norman Y. Mineta San Jose International Airport  
San Jose, California

**Owner:**  
City of San Jose

## San Jose Airport



## Expansion Joint Systems

### Flushline Systems

- Flush Elastoprene® gasket minimizes sightline.
- Gaskets available in 8 coordinating designer colors.
- Matching sightlines for floors & walls available.
- Wide range of frame styles accommodates various conditions.
- Single and dual seal designs provide necessary movement ranges.

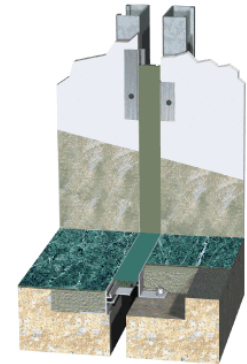

### Seismic Metal Wall Systems

- Centering bar accommodates seismic movement.
- Aluminum (standard), bronze and stainless covers.
- Standard clear anodized, optional bronze anodized or available Kynar® 500/Hylar® 5000 finishes.

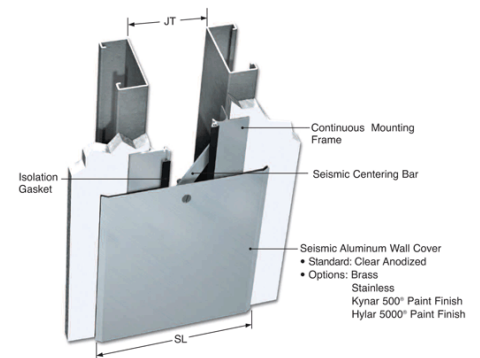

### Pyro-Flex Fire Barrier

- ASTM Test Standards E-119, E1399 and E-1966.
- Additional Standards: UL 263, UL 2079, UBC 43-1, UBC 7-1, ANSI A2.1 and NFPA 251.
- Available in 2, 3 and 4 hour ratings and cycle tested for class I, II and III movement including lateral shear.
- Listed with UL, Omega Point Laboratories, Intertek, California State Fire Marshall and ICBO Evaluation Services.

### Pyro-Flex / Blockout Floor Series

High performance continuous floor fire barrier system that maintains a seal to prevent smoke and fire spread when used with any floor expansion joint system.

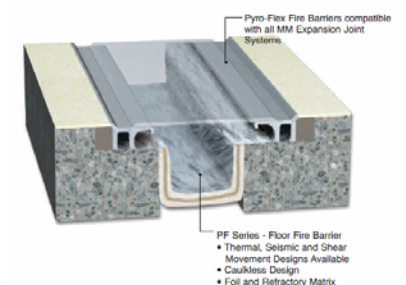



# Seattle-Tacoma International Airport

**Project:**  
Seattle-Tacoma International Airport  
Consolidated Rental Car Facility  
SeaTac, Washington

**Owner:**  
Port of Seattle

SeaTac Airport



## Expansion Joint Systems

### Seismic Slide Plate System

- Load rated heavy-duty metal slide plate with impact and sound dampener.
- Interlocking frame design insures proper alignment.
- Slide plate available in stainless steel and aluminum.
- For wide joints with multi-directional seismic movement.
- Seismic centering device with dynamic load impact dampener.
- Recessed extension plates allow smooth slab-to-slab transition.

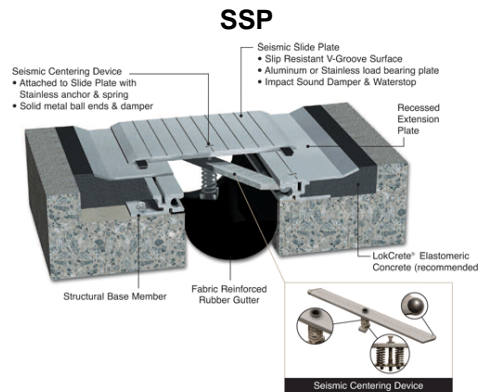

### SSP-EHD

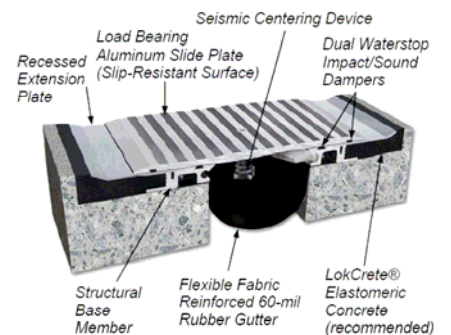



# San Francisco International Airport

# Project Profile

MM Systems Corp. • 50 MM Way, Pendergrass, GA 30567 • 800.241.3460 • 706.824.7500 • www.mmssystemscorp.com

**Project:**  
San Francisco International Airport  
Parking Garage  
San Francisco, California

**Owner:**  
San Francisco Airport Commission

## SFO Airport



## Expansion Joint Systems

### Epoxy Bonded Sealing System

- No blockouts required - waterproof sealing system becomes integral with concrete deck.
- Tenacious thixotropic epoxy anchoring system bonds seal to concrete, aluminum and steel.
- ADA compliant seal profile provides pedestrian friendly walking surface.
- Engineered to withstand heavy traffic loads, UV, ozone, acid rain, most chemicals and extreme temperatures.
- Capable of thermal, seismic, vertical and lateral shear movement.
- Accommodates complex miters and changes in direction.
- Available with 5-year warranty through Certified Contractor Network.

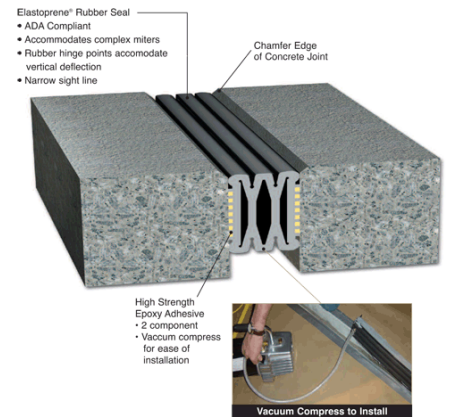

### Vertical Sealing System

- No visible aluminum or hardware.
- Engineered for multi-directional seismic movement.
- Visual seals are available in standard and custom colors.
- Resistant to UV, ozone, acid rain, most chemicals and extreme temperatures.
- Splices can be heat welded or bonded with specialty adhesive. Continuous lengths in most applications.

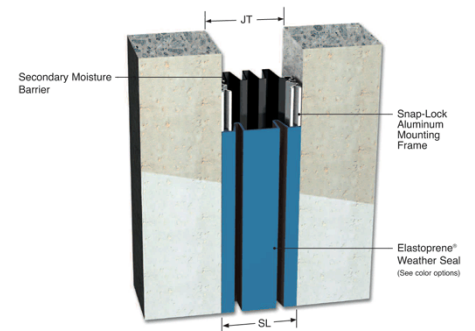



# Theodore Francis Green State Airport

## T.F. Green Airport



**Project:**  
T.F. Green State Airport  
Warwick, Rhode Island

**Owner:**  
State of Rhode Island

### Expansion Joint Systems

#### Flushline Systems

- Flush Elastoprene® gasket minimizes sightline.
- Gaskets available in 8 coordinating designer colors.
- Matching sightlines for floors & walls available.
- Wide range of frame styles accommodates various conditions.
- Single and dual seal designs provide necessary movement ranges.

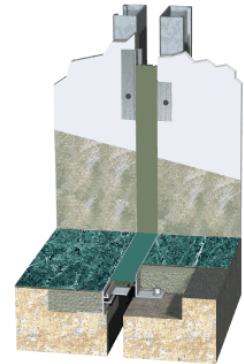

#### Metal Wall and Ceiling Systems

- Available in aluminum (standard), brass or stainless laminate covers.
- Standard clear anodized, optional bronze anodized or available Kynar® 500/Hylar® 5000 finishes in 72 standard and custom colors.
- Isolation seal protects finishes during movement.
- Frame design accommodates wall and ceiling applications.

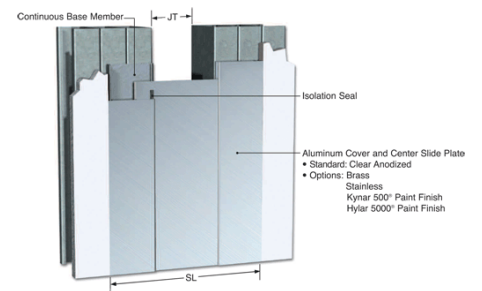

#### Metal Roof and Wall Joint Systems

- Aluminum systems feature seismic centering bars.
- Aluminum covers may be engineered to resist snow and wind loads.
- Standard mill finish, optional clear and bronze anodized or available Kynar® 500/Hylar® 5000 finishes in 72 standard and custom colors.

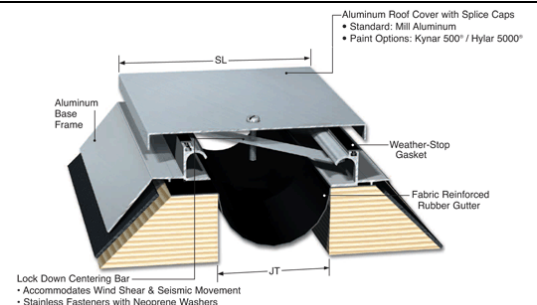



# Tampa International Airport

# Project Profile

MM Systems Corp. • 50 MM Way, Pendergrass, GA 30567 • 800.241.3460 • 706.824.7500 • www.mmsystemscorp.com

**Project:**  
Tampa International Airport  
Tampa, Florida

**Owner:**  
Hillsborough County Aviation Authority

## Tampa Airport



## Expansion Joint Systems

### Flexible Wall and Ceiling Systems

- Seals available in coordinating decorator colors.
- Multiple styles accommodate various conditions.
- Replaceable Elastoprene® seals for maintenance or décor changes.
- Mud-in frame (model VSW) for gypsum walls reduces exposed surface sightline.

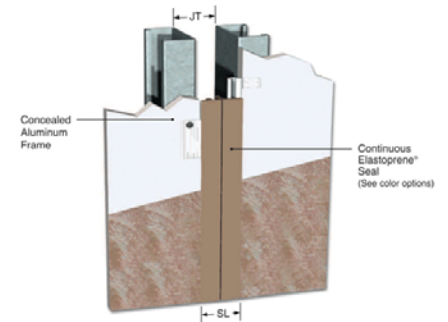

### Metal Wall and Ceiling Systems

- Available in aluminum (standard), brass or stainless laminate covers.
- Standard clear anodized, optional bronze anodized or available Kynar® 500/Hylar® 5000 finishes in 72 standard and custom colors.
- Isolation seal protects finishes during movement.
- Frame design accommodates wall and ceiling applications.

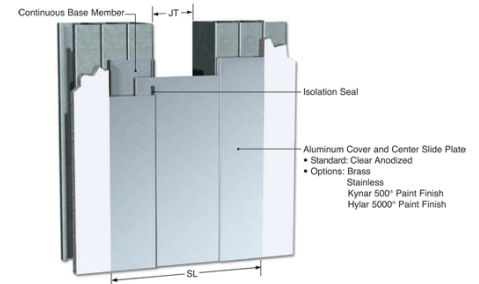

### Elastoprene Compression Seal System

- No mechanical anchors or metal components.
- Splices can be heat welded or bonded with specialty adhesive.
- Seal profiles are ADA compliant and provide a smooth transition for pedestrian traffic areas.
- Model ECS is available in continuous lengths for horizontal applications.
- High abrasion and ultraviolet resistance.
- Cost effective and easy to install.

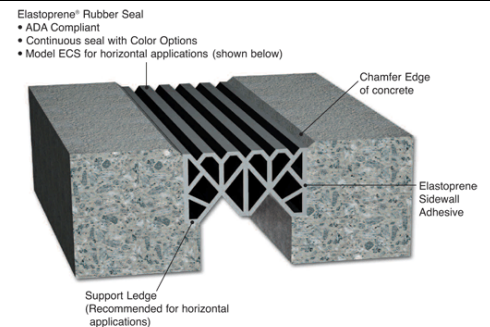



# Toledo Express Airport

**Project:**  
Toledo Express Airport  
Toledo, Ohio

**Owner:**  
Toledo-Lucas County Port Authority

Toledo Airport



## Expansion Joint Systems

### Metal Wall and Ceiling Systems

- Available in aluminum (standard), brass or stainless laminate covers.
- Standard clear anodized, optional bronze anodized or available Kynar® 500/Hylar® 5000 finishes in 72 standard and custom colors.
- Isolation seal protects finishes during movement.
- Frame design accommodates wall and ceiling applications.

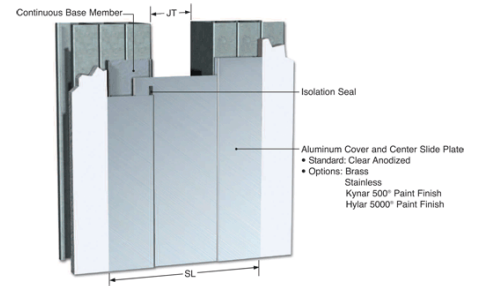

### No Bump Floor Cover Systems

- Flush, no-bump designs ideal for bump sensitive applications.
- Variable recesses accommodate a variety of floor finishes: carpet, tile, terrazzo, stone pavers, etc.
- Thermal and seismic movement range designs. No Bump Systems remain flush only during thermal movement cycles (generally in interior, climate controlled environments). During seismic or other extreme movements, No Bump Systems will not remain flush to adjacent floor surfaces.
- Available in aluminum (standard), brass and stainless steel covers.

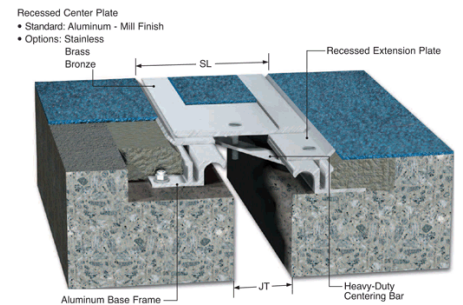



# Toronto Pearson International Airport

## GTAA Airport



**Project:**  
Toronto Pearson International Airport  
Toronto, Ontario  
Canada

**Owner:**  
Transport Canada

## Expansion Joint Systems

### Seismic Slide Plate System

- Load rated heavy-duty metal slide plate with impact and sound dampener.
- Interlocking frame design insures proper alignment.
- Slide plate available in stainless steel and aluminum.
- For wide joints with multi-directional seismic movement.
- Seismic centering device with dynamic load impact dampener.
- Recessed extension plates allow smooth slab-to-slab transition.

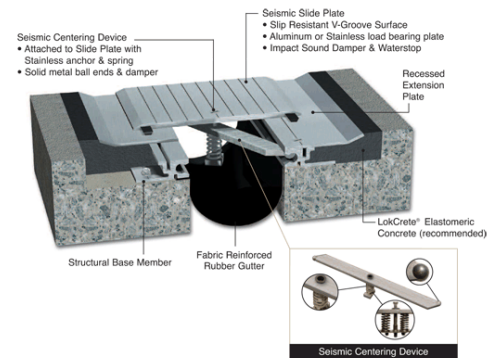

SSP Curb Transition



SSP Curb Transition





# Wilmington International Airport

# Project Profile

MM Systems Corp. • 50 MM Way, Pendergrass, GA 30567 • 800.241.3460 • 706.824.7500 • www.mmsystems.com

**Project:**  
Wilmington International Airport  
Wilmington, North Carolina

**Operator:**  
Airport Authority

## Wilmington Airport



## Expansion Joint Systems

### Vertical Sealing System

- No visible aluminum or hardware.
- Engineered for multi-directional seismic movement.
- Visual seals are available in standard and custom colors.
- Resistant to UV, ozone, acid rain, most chemicals and extreme temperatures.
- Splices can be heat welded or bonded with specialty adhesive. Continuous lengths in most applications.

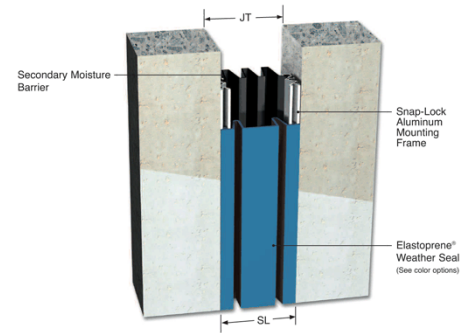

### Metal Wall and Ceiling Systems

- Available in aluminum (standard), brass or stainless laminate covers.
- Standard clear anodized, optional bronze anodized or available Kynar® 500/Hylar® 5000 finishes in 72 standard and custom colors.
- Isolation seal protects finishes during movement.
- Frame design accommodates wall and ceiling applications.

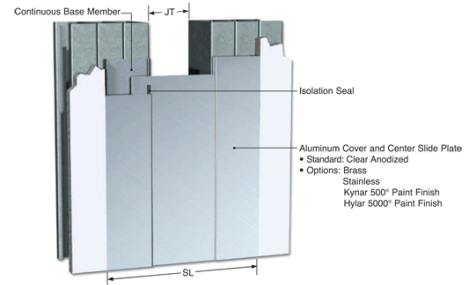



# MM Systems Corporation

## *Since 1960*

### *Heritage*

1960 marked the pivotal year of a classic American entrepreneurial enterprise. Christened as Miscellaneous Manufacturing Corporation, our Company had an instant pedigree in engineered architectural specialties.

By 1960, our founders, Julian Attaway and Don Howell had successfully launched Attaway & Howell, a full-service manufacturer's representative agency and distributor of construction products. Attaway & Howell was a dominant force in the local Atlanta construction market providing take-off, pricing, engineering and jobsite support for the products they sold.

In 1960, Mr. Attaway and Mr. Howell dreamed of their own manufacturing facility, a national and international sales presence and, of course, quality products and services that met the needs of an increasingly sophisticated construction market. Armed with this vision and conviction that a business that treated its customers by the Golden Rule would surely prosper, Miscellaneous Manufacturing Corporation was born along with our first product line – expansion joints.

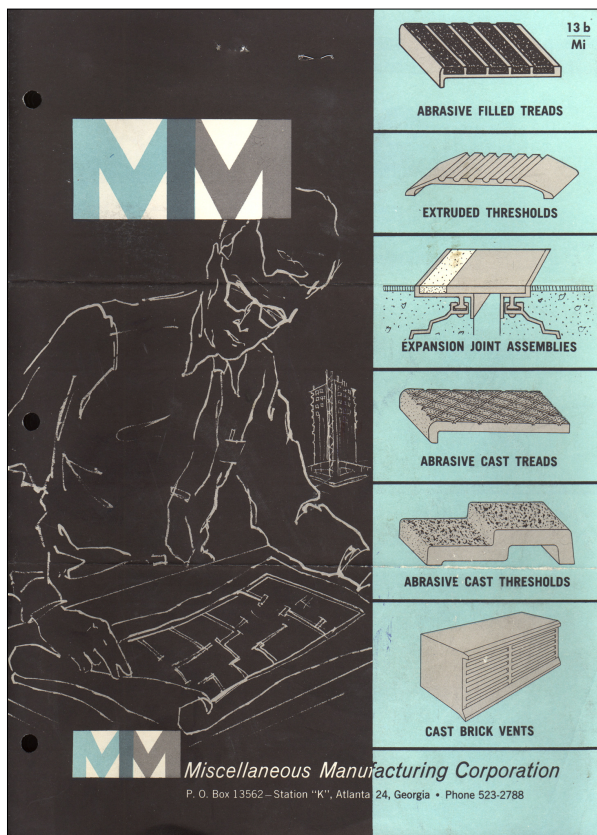

Since 1960 our product line has grown and diversified. Some early ventures, such as expansion joints and architectural metal works, have emerged as the products of choice in their respective markets.

The commitment to strong product development has been articulated by our management as a major strategy for growth into the next millennium. Today, each of our product lines is considered the standard by which all others are measured. Each of our products is engineered to provide the same quality and value that designers and contractors have come to expect.

Since 1960 our ability to service increasingly complex products and site conditions has grown along with our physical plant. Our own in-house finishing facility allows us to offer high performance architectural coatings in an unlimited array of colors. Complimentary budgets pricing along with technical consultation services have generated affordable solutions to complex applications.

# 1960

In 2000 we began to conduct on-site and factory installation seminars for our customers to help insure successful installations. In 2001 we fulfilled a dream by expanding into our current facility allowing us to more efficiently serve our customers.

Since 1960, our corporate identity has evolved to reflect an ever-increasing family of products and services. Miscellaneous Manufacturing Corporation became MM Corporation and later the more contemporary MM Systems that we are known as today.

Our current logo symbolizes the heritage of our past and our present status as a leader in the engineered construction products market. We proudly remind our customers that MM is a world-class manufacturer with the people and determination to meet any project requirements anytime, anywhere in the world.

## **VALUES**

*We believe in treating every company we do business with the same way that we would wish to be treated. We do this through our core values by constantly striving for and maintaining:*

## **CAPABILITY**

*State-of-the-art research, testing and manufacturing facilities to support and serve the needs of project designers and contractors.*

## **CRAFTSMANSHIP OF ANOTHER ERA**

*Quality and attention to detail from design through installation and inspection. Each completed project is our best form of advertising.*

## **FLEXIBILITY**

*Design solutions tailored to meet your unique project requirements rather than the cookie cutter approach offered by others.*

## **QUALITY ASSURANCE**

*Technical support provided with skill and commitment through field technicians, local representatives, a certified contractor network and the strongest joint-and-several warranty in the industry.*

## **IMAGINATION**

*Consider us old-fashioned, but MM believes that customers deserve more than a cookie-cutter approach to their needs. Each project is unique and requires individual attention tailored to its needs. We are committed to using our considerable experience to provide:*

## **TOTAL ENGINEERED SOLUTIONS**

*Offer reliable and accurate engineering services at no charge...including design consultation, budget development, AutoCAD drawings.*

## **PROBLEM SOLVING**

*We strive to earn with each new project the accolade of being the "Can Do!" company.*



***Heritage, Values and Imagination: The MM Way... May we serve you?***

# MM Product Lines



## Expansion Joints / Architectural

Aesthetics, innovation and durability are the hallmark of MM's line of floor, wall, ceiling and roof joint cover systems. Engineered systems include features that are ADA compliant, fire-rated, no-bump and heavy-load designs capable of thermal, shear, seismic and wind-sway movement.



## Expansion Joints / Parking and Stadiums

High performance joint sealing systems designed to meet the rigorous demands of parking structures, stadiums and other open-air structures. Engineered options include systems that are waterproof, fire-rated, ADA compliant, and capable of thermal, shear and seismic movement.



## Expansion Joints / Seismic

Engineered especially for new and retrofit base-isolated structures, seismically designed, code-compliant systems provide fire-rated passage between structures before, during and after seismic events. Engineered features include multi-directional movement capability including rotation in Z axis (vertical shear). Services include design/build and design assist.



## Expansion Joints / Fire Rated / Safety

Fire barrier systems engineered and tested to current standards and code requirements. Ratings include 2, 3 and 4-hour endurance. Seismic fire barriers accommodate multi-directional movement including longitudinal shear. Vertical and horizontal systems include chase and plenum designs. Factory approved transitions insure continuity of rating throughout the structure.



## Architectural Metalwork

Engineered and fabricated to exacting tolerances, architectural metalwork by MM is available in a variety of materials and finishes. Column covers, beam wraps, light coves, sun screens or your unique designs become signature elements of your project. Choose from unlimited Kynar 500® / Hylar 5000® color coatings.



## Trench Grating and Access Covers

ADA compliant grating and trench cover systems. Decorative gratings offer an architectural alternative to traditional cast-iron gratings and are ideal for pool and plaza decks, green spaces and fountain surrounds. Removable access covers allow access to in-floor electrical and refrigeration services. Optional trench liners available.



# MANUFACTURING CAPACITY



Atlanta Based Manufacturing Campus

After nearly 4 decades of steady growth and plant additions, MM Systems Corporation outgrew its manufacturing facility in suburban Atlanta.

In 2001, our office and plant operations were consolidated into a new state-of-the-art manufacturing, research and administrative facility in Pendergrass, GA, less than one-half hour from suburban Atlanta. This new facility was designed for today's capacity, but tomorrow's as well.

With a generous campus and structures designed to accommodate expansion, MM Systems is poised for growth and efficiency for decades to come.

The campus contains production facilities for:

- ◆ EJP – Exterior / Parking Expansion Joints
- ◆ EJA – Architectural Expansion Joints
- ◆ AM - Architectural Metalwork
- ◆ TA – Trench Grating & Access Covers.

## CAPACITY

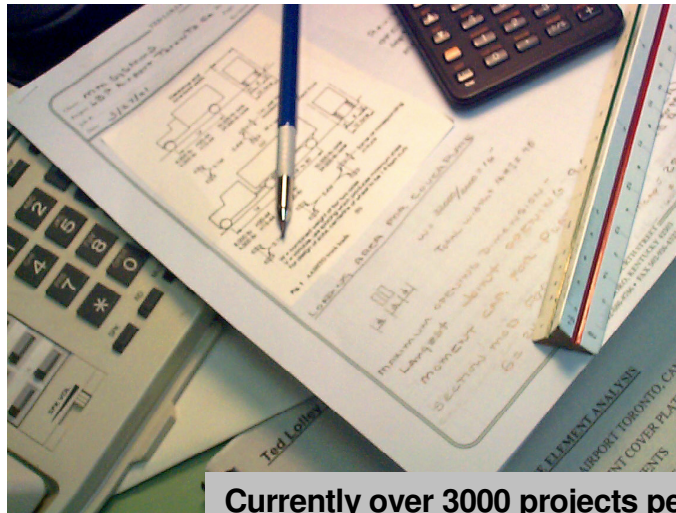

**Currently over 3000 projects per year**

MM Systems Corporation provides the necessary estimating, sales and engineering support for over 3000 expansion joint projects per year. Our recent relocation and expansion will accommodate the significant anticipated growth called for in our long-range strategic planning.

MM Systems has built a service team to respond to the demands of today's design-build construction market place.

### **The Service Team Includes:**

- ◆ **Estimating Services**
- ◆ **Engineering & Cad Design Services**
- ◆ **Customer Service & Order Management**
- ◆ **Project Management Department**
- ◆ **Production Scheduling & Inventory Control**
- ◆ **Technical Field Service Department**
- ◆ **Research & Development**

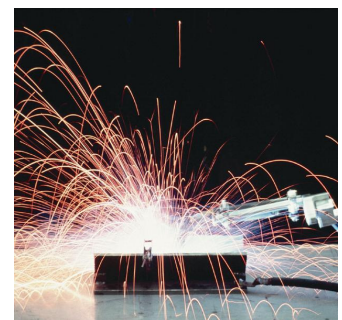

## Capability & Delivery Lead Times

Our Distribution Center and Manufacturing Facility position MM Systems to be able to respond quickly to the challenging demands of today's construction market place. Most exterior expansion joint system components are carried in inventory so as to supply the rapid demands of the parking structures rehabilitation market. MM Systems vendors are set to deliver product inside of a two-week window.

MM Systems has built a campus of production facilities to respond to the demands of today's design-build construction market place.

### The Production Facilities Includes:

- ◆ Primary Manufacturing Plant
- ◆ Warehousing and Distribution Center
- ◆ Fire Barrier Manufacturing Facility
- ◆ Kynar® 500 / Hylar® 5000 Finishing Facility
- ◆ Administrative Offices

We strive to earn with each new project the accolade of being the “**Can Do**” company.

since  
**MM Systems Corporation**  
1960



## Committed to **PRESERVING** our Environment...

1960 was the year that Julian Attaway, the founder of MM Systems, dreamed of owning a manufacturing facility with a national and international sales presence and, of course, quality products and services that met the needs of an increasingly sophisticated construction market. Armed with this vision and a conviction that a business that treated its customers by the Golden Rule would surely prosper.

Times have changed since 1960, and now more than ever, companies need to join together to help protect our environment for future generations to come. So in the spirit of Julian's adoption of the Golden Rule, current President Mike Attaway has committed to expanding it to a complementary standard - the Green Rule - treat the environment the way we would like to leave it for the next generation and generations to come.

To accomplish this MM Systems has committed to fostering environmentally friendly green manufacturing practices to help meet present needs for sustainable construction products without compromising the ability of future generations to meet their needs.

As a start, MM Systems joined the US Green Building Council and other Eco-Friendly Organizations to partner with professionals and companies who are committed to the protection of the environment through the development and promotion of sustainable products and green building practices. Other specific green initiatives include the following:

### **MM Systems Paint Byproducts Make Their Way In To Concrete**

MM Systems applies paint finishes that will preserve the quality of our steel and aluminum products for up to 20 years. These finishes significantly reduce product maintenance and consumption of environmental resources through extended life cycle utilization. However, the painting process produces several waste byproducts. In lieu of these byproducts ending up in a land-fill, they go through two additional steps of use before becoming a part of another sustainable construction project. Because of our commitment to environmental stewardship, MM Systems partnered with an environmental waste management company to use these paint byproducts in a fuel-blending kiln. The residue and ash from the fuel blending process is further recycled and blended as filler for new concrete.

### **MM Systems Regrind, Recycle, and Reuse**

MM Systems elastoprene thermo-plastic rubber seals are produced through a state of the art manufacturing process that allows 100% of all raw material to end up as a finished construction product. We accomplish this through the utilization of special re-grinding equipment and dryers. This equipment allows our perpetual recycling process to re-consume material drops out of tolerance material that occurs as a natural part of the extrusion process.

### **MM Systems Aluminum Recycling Program**

Long ago, MM Systems committed to environmental stewardship by selecting aluminum as one of our key product components due to the cost efficient ease of reprocessing and recycling all associated waste. MM Systems aluminum products are certified as having over 50% recycled aluminum from post-industrial recycle and post-consumer recycle.

We don't just buy recycled components but we also contribute to the recycling process by making sure that all of our scrap aluminum that is generated from the fabrication of expansion joint systems is recycled to become a new generation of products.



Easily find *anything* you need on our web site...

**www.mmsystemscorp.com**



*Your Direct Link to  
Expansion Joint  
Solutions*



◀ **Download and View...**

- Spec Data Sheets
- CSI 3-Part Specifications
- Color Design Guide
- Project Reference List
- CAD Drawings

*Additional MM Systems  
Products to Meet All  
Your Needs*

- ej<sup>a</sup>** Expansion Joints / Architectural
- ej<sup>p</sup>** Expansion Joints / Parking & Stadiums
- ej<sup>s</sup>** Expansion Joints / Seismic
- fb** Fire Rated / Safety
- am** Architectural Metalwork
- ta** Trench Grating & Access Covers
- re** Architectural Roof-Edge Technologies



**MM**  
MM SYSTEMS

50 MM Way, Pendergrass, GA 30567 • 800.241.3460 • [www.mmsystemscorp.com](http://www.mmsystemscorp.com)